

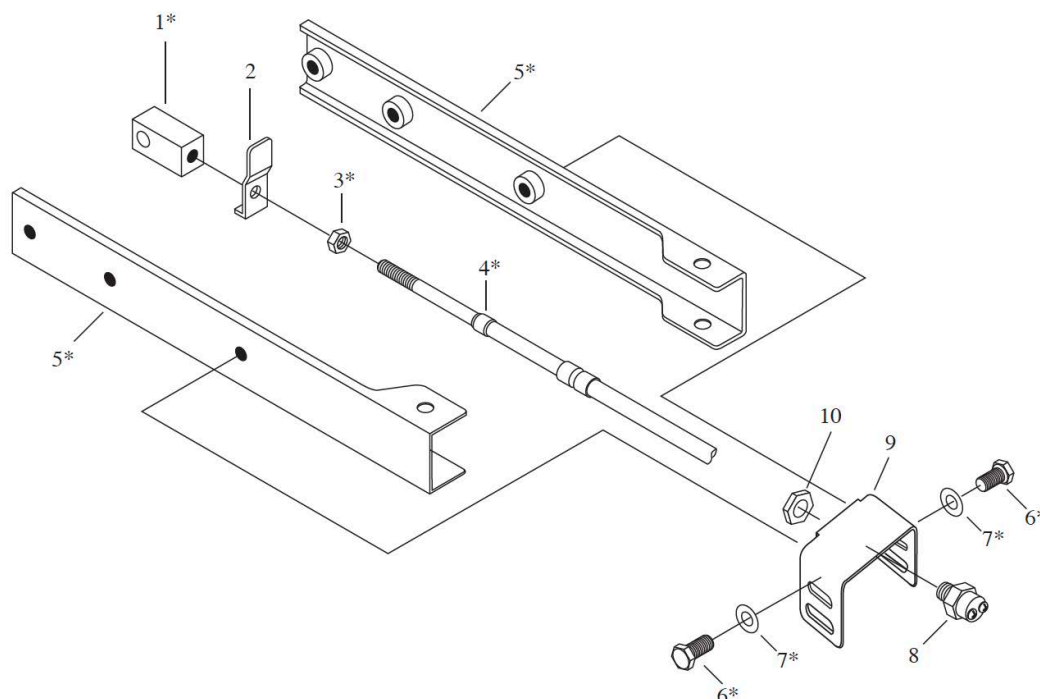

Winters Performance Products, Inc.
 1580 Trolley Road
 York, PA 17408 USA
 717-764-9844
www.wintersperformance.com

SAFETY SWITCH KIT P/N 1089



#	Description	P/N	QTY	#	Description	P/N	QTY
1*	Clevis	6647	1	6	1/4-20 x 1/2" HHCS	7941	2
2	Contact Bracket	1087	1	7	1/4" Flat Washer	7131	2
3*	1/4-20 Jam Nut	7926	1	8	Safety Switch	1088	1
4*	Cable (5 Foot Cable)	6014-60	1	9	Switch Bracket	1086	1
5*	Side Bracket	6643	2	10	9/16 Pal Nut	7951	1

1. Install contact bracket (2) on cable (4). Tighten jam nut (3) so contact bracket is securely held against the clevis (1).
2. Move shifter to the 'park' position.
3. Install safety switch (8) and wire leads into the switch bracket (9) and tighten Pal nut (10).
4. Install switch bracket on to side brackets (5) using 1/4-20 x 1/2" HHCS (6) and 1/4" flat washers (7). Do Not tighten screws.
5. Slide switch bracket forward until contact bracket depresses button on safety switch. Tighten screws to hold this position.

Note: Switch button must be depressed in order to complete the circuit in the switch

Items marked with (*) are for reference only and not included in the kit.